

 **RELEASE NOTES**

Altair[®] Inspire[™] Cast

2022.1 and 2022.1.1

New Features and Enhancements 2022.1

Altair Inspire Cast 2022.1 includes the following new features and enhancements.

Release Highlights

Demolding Angle Tool

You can now view the surfaces that may cause the part to stick during demolding, change the demolding tolerance angle, and change the axis along which the mold will open.

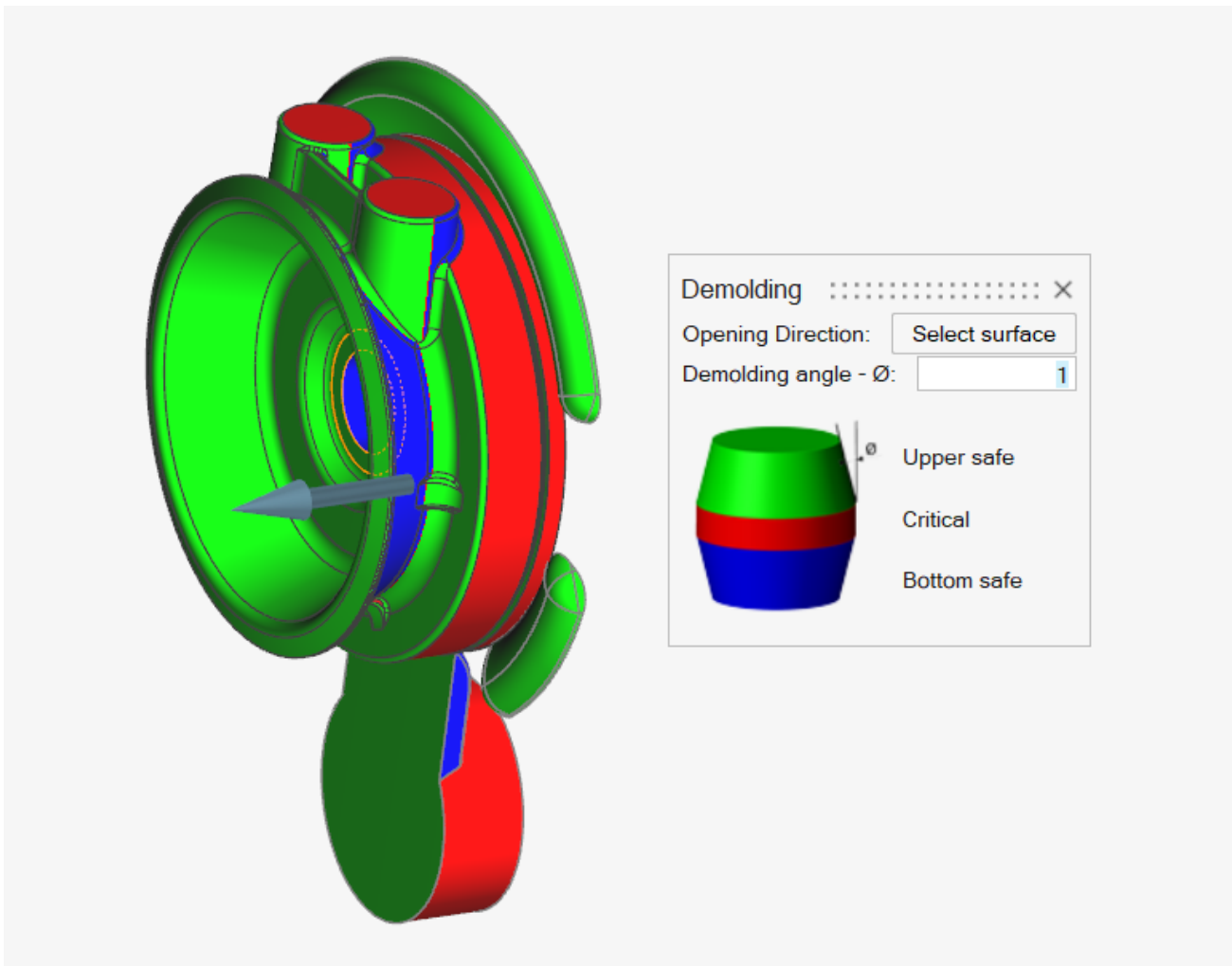

Additional Changes and Enhancements for 2022.1

- Update to the Gravity Casting process:
You can now set the liquid velocity in the Gravity Process Parameters window when Constant Liquid Level is selected.
- Improvement to the solver:
Thermomechanical analyses are now much faster.

New Features and Enhancements 2022.1.1

Altair Inspire Cast 2022.1.1 includes the following resolved issues.

Resolved Issues

- Added new files to minimize false positives detected by antivirus programs.
- Fixed an issue that occurred when running cycling and filling analysis with a shot sleeve.

Learn More About Inspire

You can learn more about new and existing features in Inspire using the following resources:

In-Application User Assistance

Inspire provides two types of user assistance. **Enhanced tooltips** appear when you hover over icons and other features. They describe what the tool does.

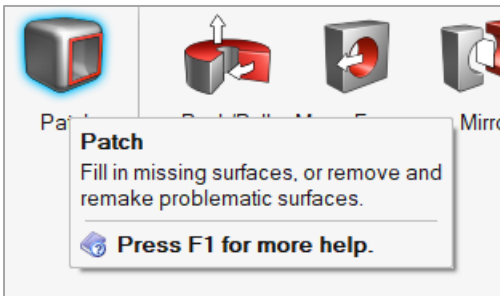

Workflow help appears when you select a tool that opens a guide bar or microdialog. The text prompts you what to do next.

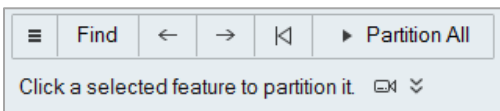

Click to view additional tips and shortcuts. Some tools also include a video .

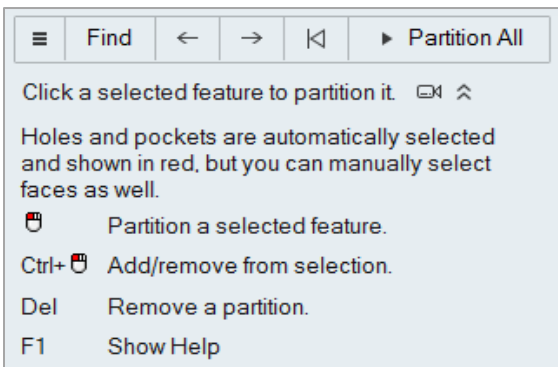

Online and Offline Help

Press **F1** or select **File > Help > Help** to view the online help.

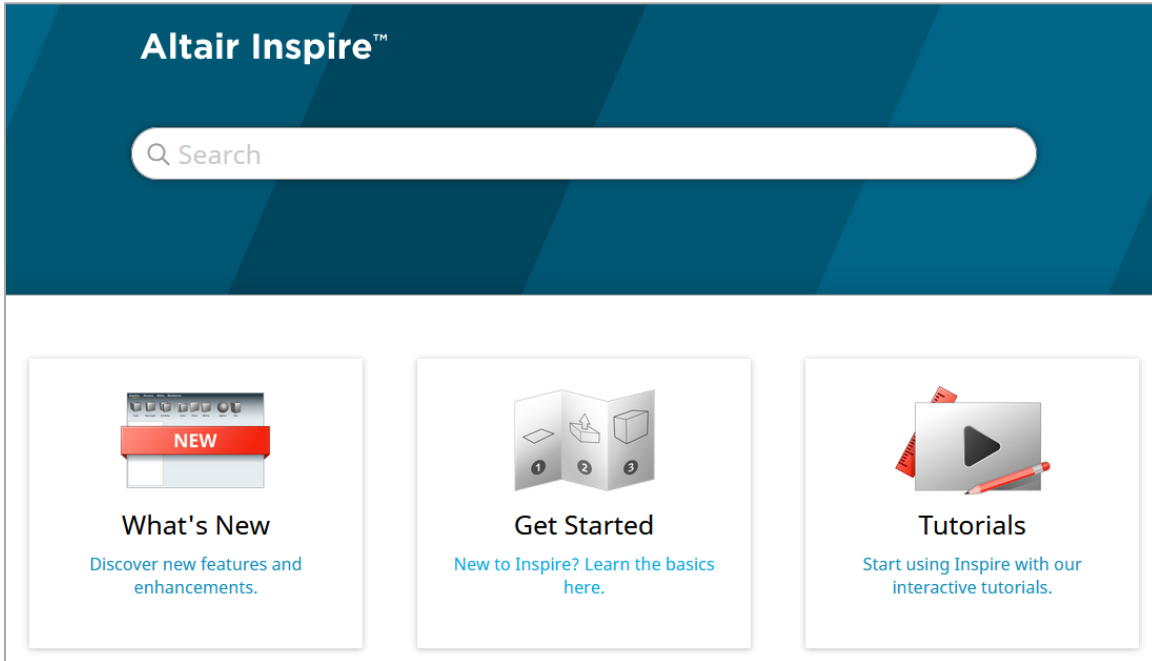

You can download an offline version by selecting **File > Help > Download Offline Help**. An internet connection is required to download.

